

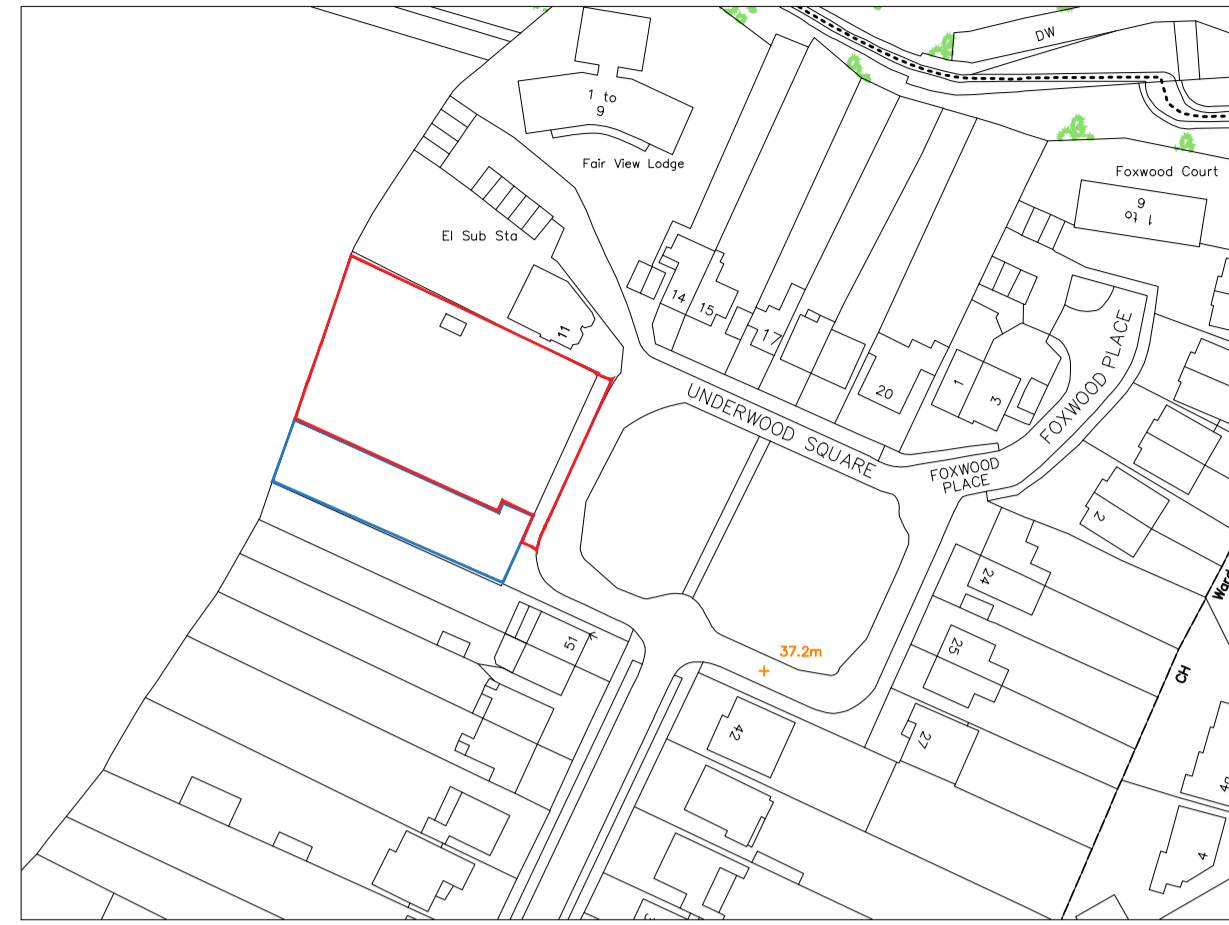

EXISTING BLOCK PLAN - 1:500

NORTH



EXISTING LOCATION PLAN - 1:1250

NORTH



CURRENT CONSENT - BLOCK PLAN - 1:500

NORTH

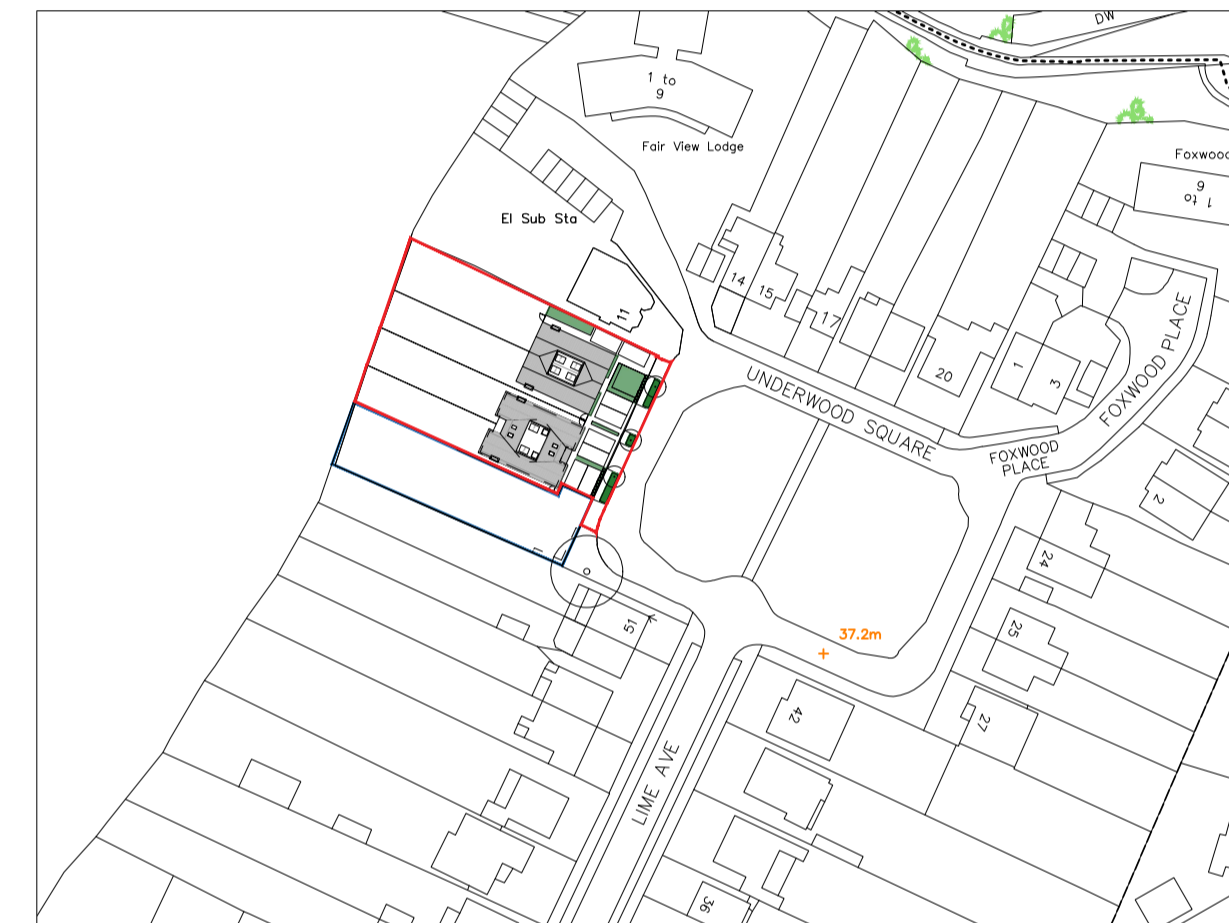

CURRENT CONSENT - LOCATION PLAN - 1:1250

NORTH

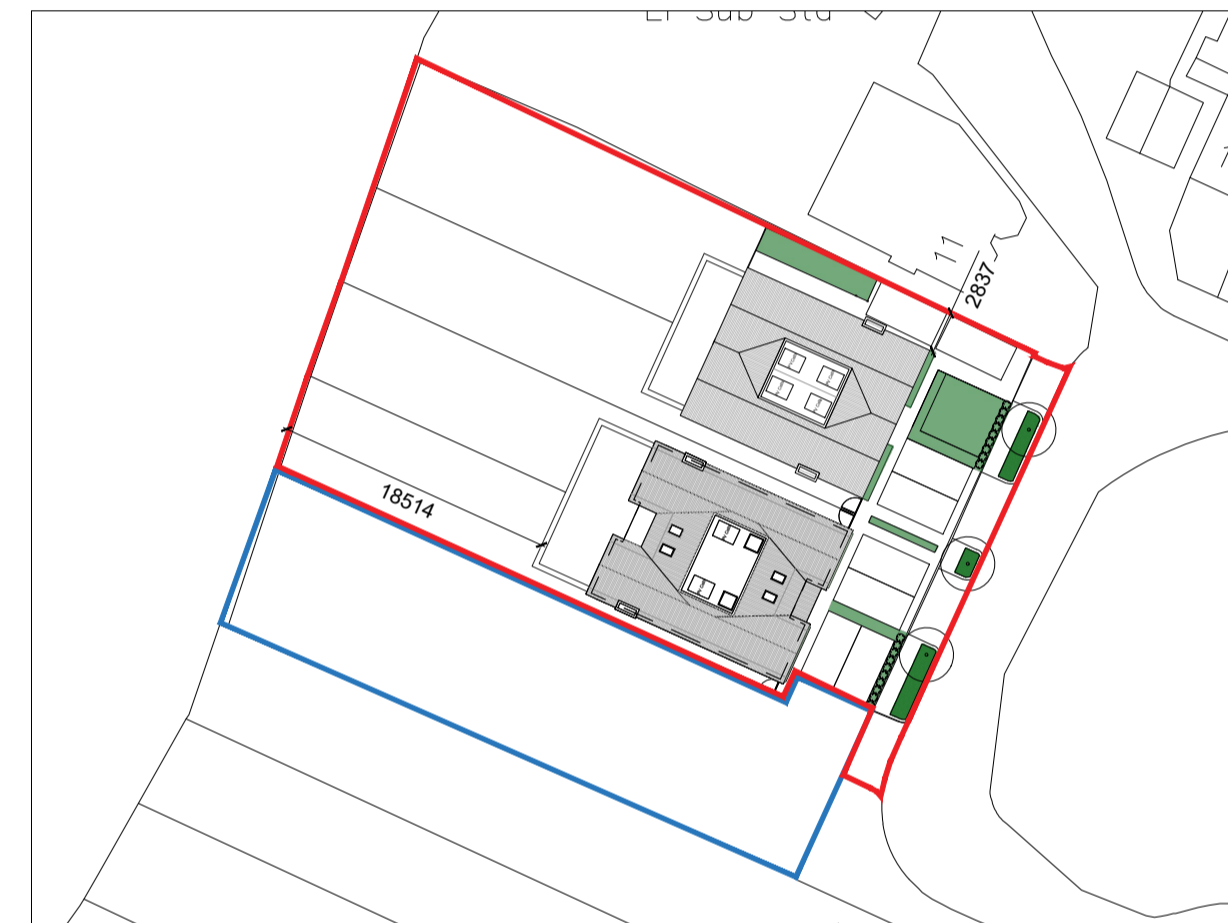
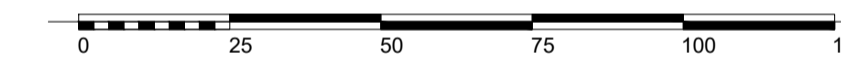

PROPOSED BLOCK PLAN - 1:500

NORTH

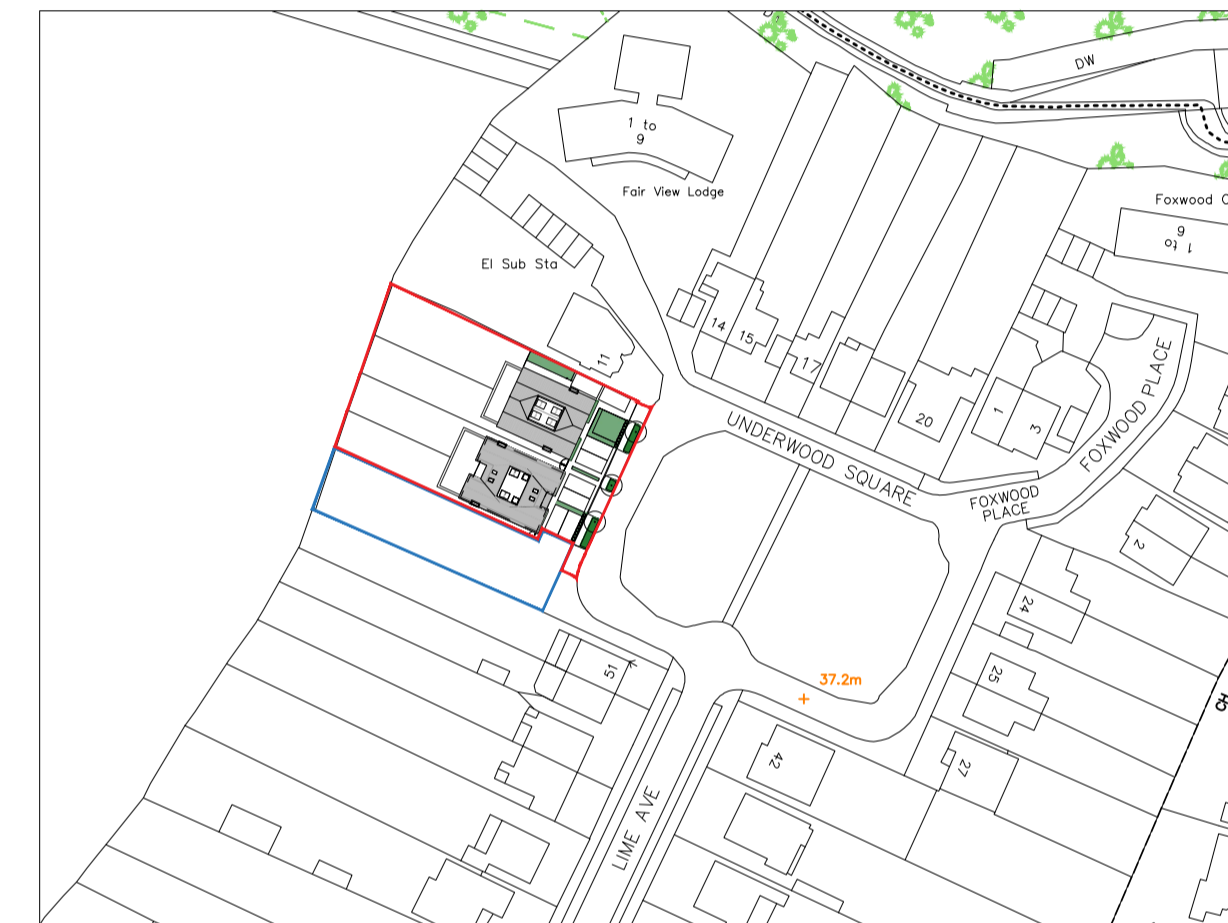

PROPOSED LOCATION PLAN - 1:1250

NORTH



CURRENT CONSENT PLANNING REFERENCE:  
18/01063/FUL  
DATED 3RD OCTOBER 2018



CURRENT CONSENT - INDICATIVE STREETSCENE - 1:100

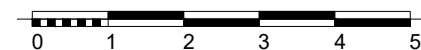

Notes:			

Rev	Comment	By	Date
A	-	DS	27/07/2020
-	-	DS	02/07/2020

Stage:  
3 - Developed Design

Client:  
Mr G Newton

Project:  
Hayden House  
10 Underwood Square  
Leigh - on - sea  
SS9 3PB

Drawing Title:  
Site and Block Plans

Drawing no: 385-P100      Revision: A

Project no: 385      Drawn by: DS, WRS

Scale: 1:100, 1:500, 1:1250 @ A1      Chkd by: SK

**SKARCHITECTS**  
833-855 London Road  
Westcliff-on-Sea  
SS9 9SZ  
Tel: 01702 509250  
Email: info@skarchitects.co.uk

Do not quote from this drawing.  
Drawing to be kept in conjunction with all other issued drawings, documents and relevant consultants' information.  
No alteration to this drawing for guidance purposes only. All dimensions must be to finished work.  
This information is subject to Building Control requirements and the requirements of all relevant statutory authorities and service providers.  
© Skarchitects Ltd 2018